

# 092/23 Double Stage Filters for Sports and Fitness Equipment

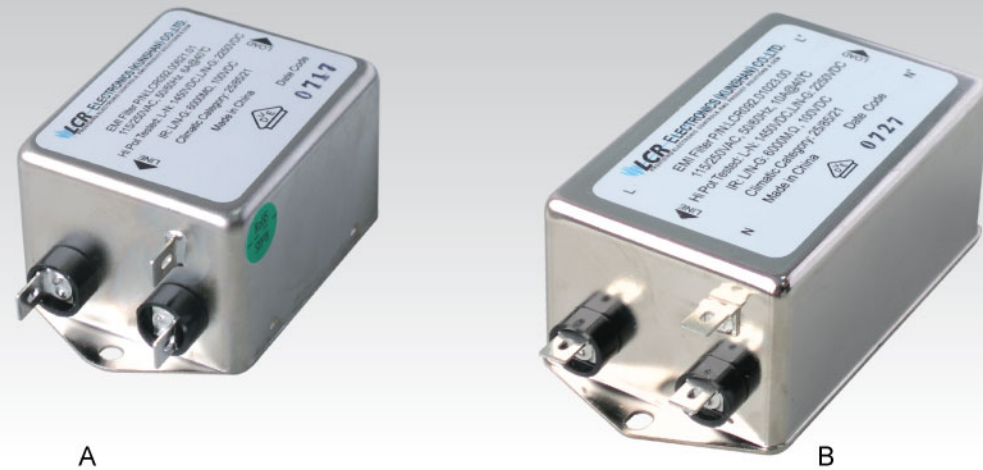

## Features

High performance EMI filters specially designed for sports and fitness equipment.

## Typical Applications

Sports equipment, steppers, treadmills and other frequency inverter applications that requires high noise suppression.

## Technical Data

Rated Voltage Max. (V)	250VAC	Leakage Current 092/23 Series	
Rated Current (A)	4 - 20A @ 40°C	@ 250 VAC 50 Hz	1.8 mA Max.
Operating Frequency (Hz)	50 / 60Hz	@ 115 VAC 60 Hz	1 mA Max.
Hipot Rating	Line to Line	IP Standard	65
	Line to Ground	Climatic category	25 / 85 / 21
Case	Plated steel		
Packaging Quantity	60/45 pcs per carton		

Model No.	Rated Current @ 40°C	Mechanical Diagram	Unit Weight (g)	Terminal Options	
				In	Out
092.00423.00	4.0	A	195.0	Faston 6.35*0.8	Faston 6.35*0.8
092.00623.00	6.0	A	195.0	Faston 6.35*0.8	Faston 6.35*0.8
092.00823.00	8.0	B	323.0	Faston 6.35*0.8	Faston 6.35*0.8
092.01023.00	10.0	B	420.0	Faston 6.35*0.8	Faston 6.35*0.8
092.01623.00	16.0	B	400.0	Faston 6.35*0.8	Faston 6.35*0.8
092.02023.00	20.0	B	420.0	Faston 6.35*0.8	Faston 6.35*0.8

## 092 / 23 Mechanical Outlines

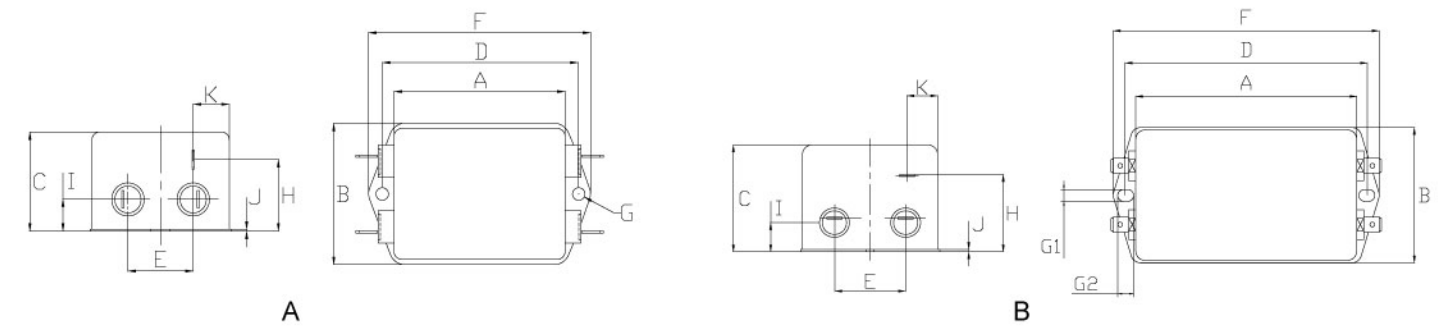

## 092 / 23 Mechanical Dimensions (mm) For reference only

Model No.	A	B	C	D	E	F	G	H	I	J	K
092.00423.00	63.2	52.0	38.0	75.0	25.0	85.0	4.8	27.5	12.3	0.6	13.3
092.00623.00	63.2	52.0	38.0	75.0	25.0	85.0	4.8	27.5	12.3	0.6	13.3
092.00823.00	92.5	58.0	41.0	105.0	30.0	115.0	5*6.8	33.0	13.0	0.8	13.5
092.01023.00	92.5	58.0	41.0	105.0	30.0	115.0	5*6.8	33.0	13.0	0.8	13.5
092.01623.00	92.5	58.0	41.0	105.0	30.0	115.0	5*6.8	33.0	13.0	0.8	13.5
092.02023.00	92.5	58.0	41.0	105.0	30.0	115.0	5*6.8	33.0	13.0	0.8	13.5

All dimensions in mm, 1 inch=25.4 mm

## Insertion Loss in dB Measured in a 50Ω System

Model No.	Common Mode IL (Frequencies in MHz)							
	0.05	0.1	0.15	0.5	1.0	5.0	10.0	30.0
092.00423.00	26.0	31.0	33.0	58.0	74.0	75.0	78.0	74.0
092.00623.00	27.0	49.0	60.0	79.0	67.0	72.0	63.0	47.0
092.00823.00	20.0	53.0	61.0	74.0	66.0	50.0	43.0	42.0
092.01023.00	22.0	28.0	33.0	58.0	74.0	73.0	74.0	63.0
092.01623.00	24.0	26.0	28.0	39.0	35.0	42.0	41.0	20.0
092.02023.00	21.0	21.0	23.0	47.0	64.0	66.0	68.0	47.0

Model No.	Differential Mode IL (Frequencies in MHz)							
	0.05	0.1	0.15	0.5	1.0	5.0	10.0	30.0
092.00423.00	30.0	50.0	59.0	70.0	67.0	68.0	61.0	57.0
092.00623.00	35.0	47.0	69.0	81.0	69.0	72.0	72.0	73.0
092.00823.00	13.0	15.0	44.0	80.0	71.0	65.0	61.0	50.0
092.01023.00	17.0	38.0	52.0	67.0	59.0	65.0	61.0	36.0
092.01623.00	28.0	31.0	31.0	38.0	46.0	55.0	39.0	47.0
092.02023.00	23.0	24.0	24.0	51.0	62.0	44.0	39.0	30.0

Other specifications, requirements and customizations can be offered upon request.

To improve Power Factor, use 018 series inductors in series with filter line.